

PDRM₂ Portable Leak Detector



A robust single channel monitor designed with flexibility in mind allowing ease of transport and mounting to a piece of equipment or in a confined space for safety purposes. Built for accuracy and reliability, the monitor uses unique infrared absorption technology and combines different sensing techniques for gas species detection.

Product Details

Versions

- Single gas species detection - HFC, HFO, CFC

Product Extensions

- Robust storage/carry case
- Pipework and accessories kit
- Wall-mount brackets
- Remote annunciation.
- Automated alarm emails and KPI's (Key Performance Indicator) using the Parasense Dashboard
- Cluster I/O configurations available

Features

- Draws a sample of air through remote tubing, analyses for content of target gas(es) and displays the results as a % or PPM
- Continuous data logging of samples and configurable alarm thresholds
- Twin sampling pumps for increased reliability and longevity
- Configurable via display/keyboard

- Built-in visual/audible alarm and fault annunciation via LED and mutable sounder

Complies With:

- NAVSEA Standard Item 009-61 FY-15
- Non-Magnetic Requirements
- UL61010-1
- CSA C22.2 61010-1
- EN61010:2010
- FCC Part 15 Subpart B
- ICES-003 Issue 5

Product Ordering Information - Monitor Only

Part Number	Gas Options
PDRM2-101	HFC/HFO/CFC

Note : To include carry case and accessories '-A' should be added to the above part numbers.
For example : PDRM2-101-A

Product Dimensions

Width	Height	Depth	Weight
15.7"	8"	5.9"	13.2lb

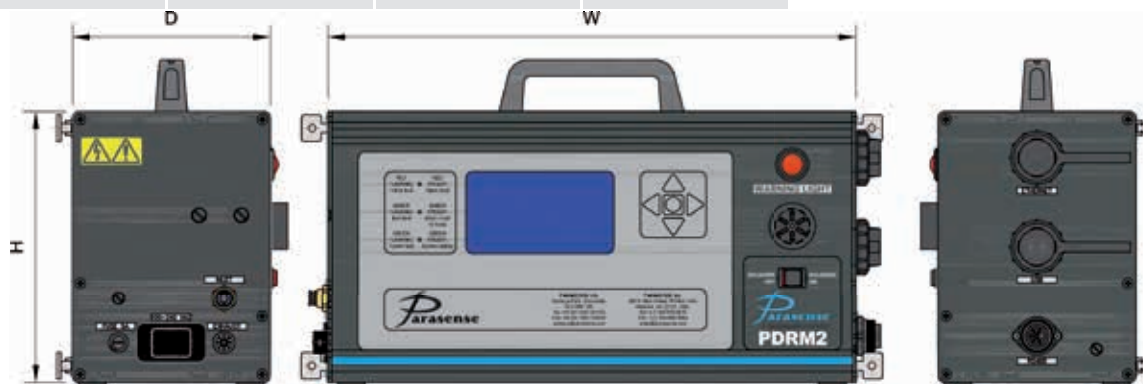

Technical Specification

Ethernet

- 10 Base-T RJ45 socket

USB

- USB2.0, Type B socket

Display & Operator Controls Options

- Traffic lights, LCD status display & navigation keypad

Sensor, CFC, HCFC, HFC, HFO

- Styx infrared absorption sensor
- 24V DC plus serial coms
- Resolution: 1ppm
- Accuracy: better than 15% (species dependant)

Sample Pumps x 2

- 24V dc, 360mA

Maximum Length of Sample Pipe

- 500ft (including all Spur pipework)

Operating Conditions

- Operating temperature: 15°F to 110°F
- Storage temperature: -10°F to 150°F
- Humidity: 0 to 95%, non-condensing

Power Requirements

- 100-240V AC, single phase, 50/60Hz
- Automatic disconnection of the supply should be provided by means of an external RCD

Overcurrent Protection

- 5A fuse, cartridge type

Cluster Network

- RS485 communication
- Network power: 24V DC max 650 mA
- Baud rate: 115kbps
- Total number of clusters dependent on application



Carry Case and Contents

Width	Height	Depth	Weight (inc contents)
24.4"	8.8"	19.4"	26.4lb

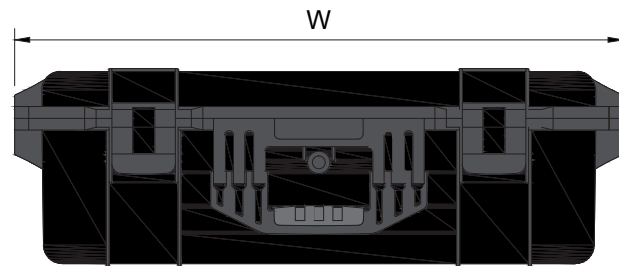
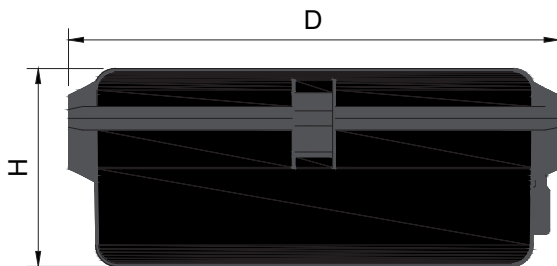

Case Contents

- Portable Leak Detector
- 10ft power cable
- 16ft sampling pipe with filter end
- Inline connector
- Y connector
- Pipe release tool
- Pipe cutter
- 10ft CAT5 cable
- RS485 connection plug
- Product CD
- Wall mount brackets



Wall-mount brackets



Parasense Ltd.
Unit 12, Olympus Park, Quedgeley, Gloucester, GL2 4NF, UK
Tel: +44 (0)1452 724123 Fax: +44 (0)1452 724234
www.parasense.com/en/

Parasense Inc.
9661 Spotswood Trail, Stanardsville, VA 22973, USA
Tel: +1 (540) 948 9919 Fax: +1 (434) 990 9214
www.parasense.com